

Product Specification

——TOSA TO -Holder

1、 Application Range

Optical transceiver component interface;

2、 Materials:

Use Japanese stainless steel, such as SUS304/SUS304L etc.

All materials comply with the ROHS directive requirement—2011-65-EU.

3、 Structure sketch

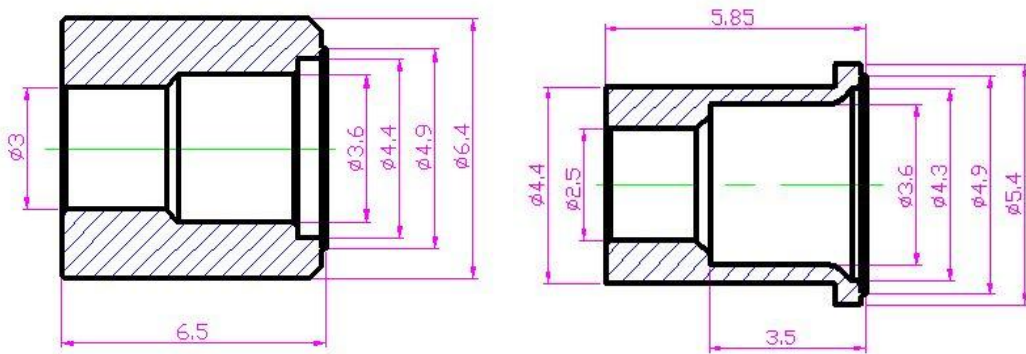

4、 Product pictures:



5、 Performance index: Symmetry, verticality, concentricity and dimensional accuracy etc.

Category	Technical requirements(unit:mm)	Remarks
Concentricity	≤ 0.01	
Roughness Ra	0.4	
Verticality	≤ 0.01	
Flatness	≤ 0.01	



6、Visual inspection standard

See FT-QT14-305-2009 《Visual Inspection standard on conventional stainless products》